

UNIVERSAL ISU165

Product Data Sheet

2-way component kit

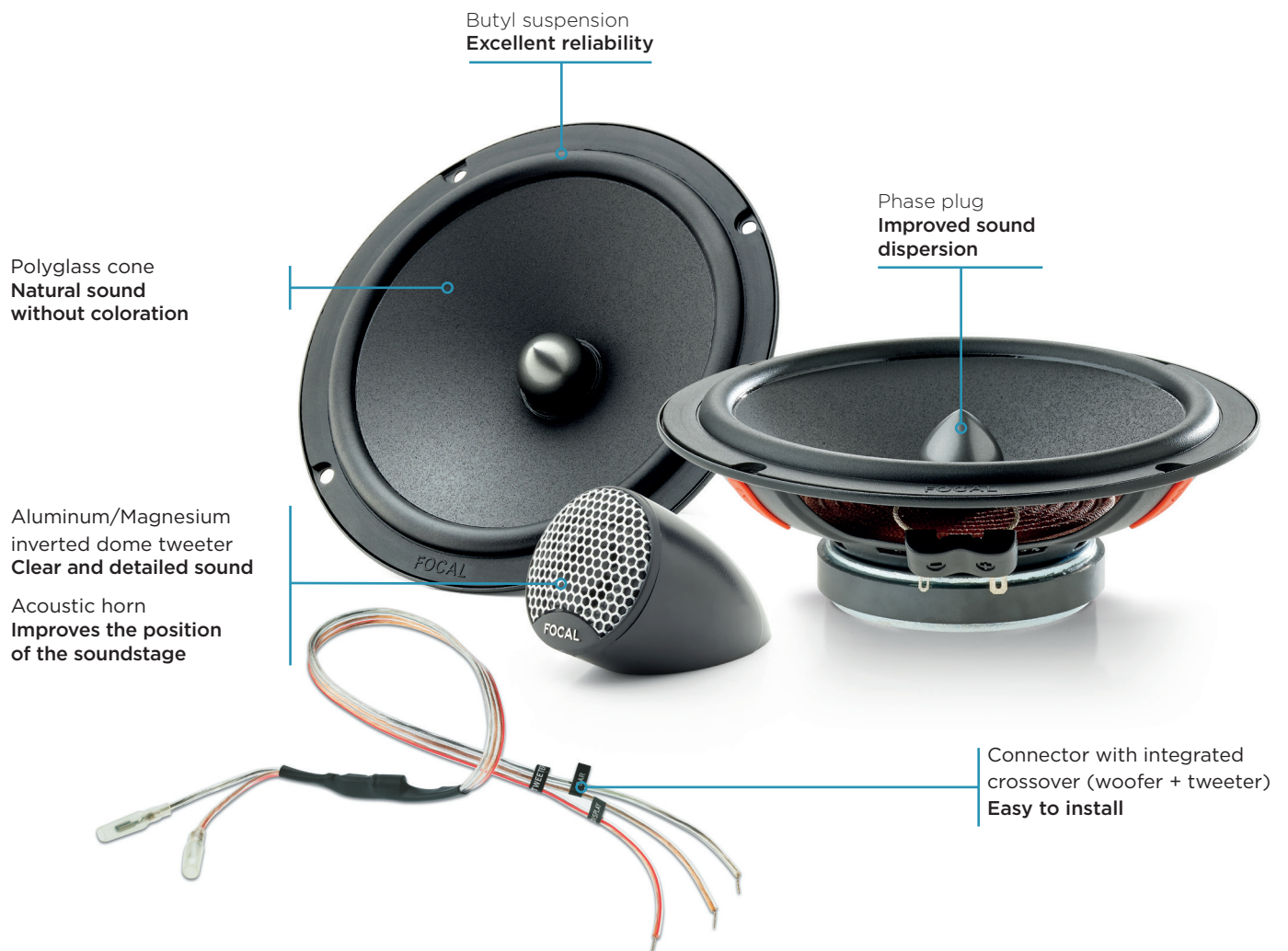

ADVANTAGES

- High sensitivity
- Shallow mounting depth (1²⁹/₃₂" - 48.4mm)
- Dynamics and neutrality
- 2 types of tweeter mounts
- Compact tweeter



Detachable tweeter



Tilted mounting frame:
Easy to install



Mounting options:
car and display

TECHNICAL CHARACTERISTICS

Woofer: 6¹/₂" (165mm)
Voice coil diameter: 1" (25mm)
Max. power: 140W
Nom. power: 70W RMS

Sensitivity (2.83V/1m): 93dB
Frequency response: 60Hz-21kHz
Al/Mg inverted dome tweeter
Accessories: delivered without grilles

Integrated crossover: 6dB/oct

Integration
INSTANT GRATIFICATION

Focal is a trademark of Focal-JMlab -TéL. (33) 04 77 43 57 00 - www.focal.com - Images may not conform exactly to specific product.
Photos L'Atelier Sylvain Madelon-SCAA-170908/3

FOCAL
LISTEN BEYOND