

SWC Adapter **42a-1094-026**

for vehicles Citroen, Fiat, Opel, Peugeot

Detailed information on vehicle models, connections and functions can be found in our webshop under <https://shop.acvgmbh.de>
Enter the item number in the search box. You will then be taken to the item description.

Before installation

Read the instructions before installing. Technical knowledge is required to install the adapter. The installation site must be free of moisture and away from heat sources. Make sure you use the right tools during installation to avoid damage to the vehicle or product. Turn off the ignition and disconnect the vehicle battery according to the factory regulations! If the vehicle battery cannot be disconnected according to factory specifications, it is sufficient in most cases to put the vehicle to sleep mode. If this does not work, the vehicle battery can be disconnected with a resistance cable.

Connection example

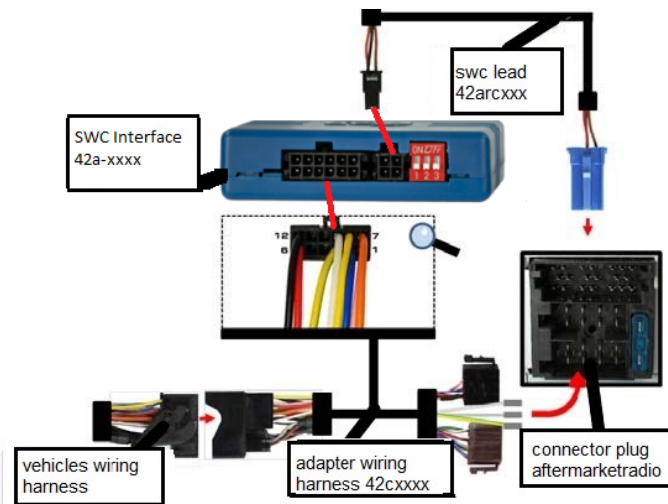

DISCLAIMER

The information contained in this document is subject to change without notice if changes are made to the product(s). This guidance is based on documented data and testing. acv GmbH cannot be held responsible for changes to vehicles (e.g. software updates, hardware replacement) for damage that may occur due to the installation of this product.

Installation

Before installing the stalk adapter, the factory radio must be removed and disconnected. Please refer to the vehicle's owner's manual or consult a professional. A connection cable to the radio for the steering wheel control is also required for installation (sold separately).

Please make sure you have the correct cable before proceeding.

1. Plug the 4-pin plug of the cable/wire into the socket of the stalk adapter.

2. Connect the other end of the cable/wire to the steering wheel control input on the back of the aftermarket radio

NOTE: Depending on the make of the retrofit radio, this can be a 3.5 mm jack plug or a 1-cable input.

For more information, please refer to the retrofit radio installation manual. In addition, the dip switches on the LFB adapter must be adjusted to the respective manufacturer/connector. (see table on page 4).

3. Connect the 12-pin connector of the supplied wiring harness to the LFB adapter.

4. Connect the 6-pin connector of our wiring harness with the gray vehicle-specific plug (located at the bottom of the dashboard or above the cup holder) Please do not connect it to the orange version!

Note: If the vehicle is equipped with a Qi charger, disconnect the plug from the charger. Plug it into the socket and the plug of our T-harness into the charger.



5. Lay the end of the wires for speed and reverse from the main opening in the Dashboard down to the fuse panel. The wires with the bare ends remain in the dashboard opening for use on the new main unit.

6. Unplug the green and black plugs from the fuse box.

7. Take the green connector and remove the blue/white cable from pin position 17 on the back of the case. Then take the orange reversing cable from the included wiring harness and connect it to the original location.

NOTE: When removing the blue/white cable from its original position, be careful not to damage the retaining clip. Should this bend, carefully bend it back into the correct shape to use it again.

8. Take the original blue/white cable in the vehicle and plug it into one of the 2-pin sockets.

Plug this 2-pole assembly into the blue housing of the supplied wiring harness.

NOTE: The position of the blue/white cable must match the position as seen from the rear of the blue plug.

9. Take the black plug and plug the green speed cable into pin position 22 on the back of the housing

NOTE: Before making these connections, make sure that the signals are present, as the position of the pins may vary depending on the vehicle.

10. Connect the power/speaker ISO connection to the power/speaker ISO connector. Connection on the back of the retrofit radio.

11. Connect the mini-ISO socket of the wiring harness to the corresponding plugs of the vehicle and test the radio and steering wheel control for correct function before reinstalling everything. If the steering wheel control does not respond, please uninstall the SWC adapter and the wiring and carefully reinstall it according to the steps above (DIP switch)!

Function of the steering wheel buttons

Although the following diagram is based on careful research, it is only an example. Individual steering wheel control configurations may vary.

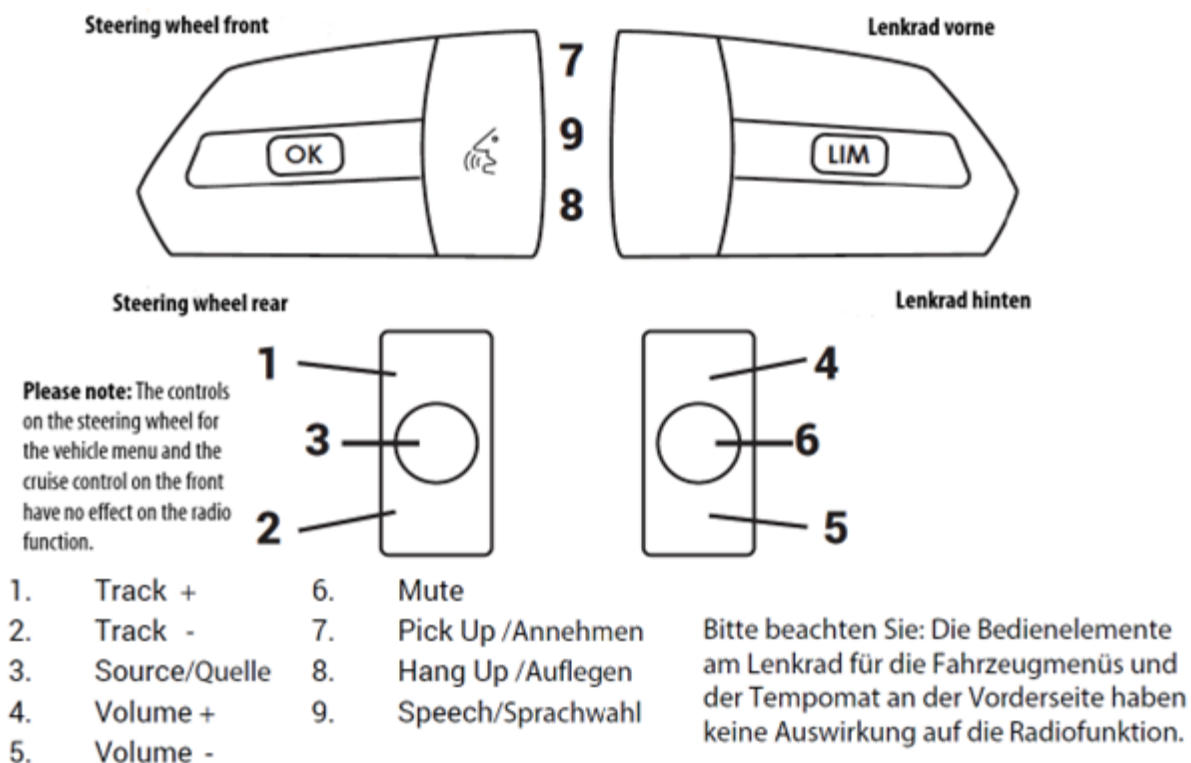

Dip switch settings



To use the steering wheel remote control, depending on the manufacturer of the connected retrofit device, a device-specific control cable 42arcxxx is required. The following table lists the control cables and the dip switch positions for the supported manufacturers.

Lead No.	Description	DIP1	DIP2	DIP3
42arc000	SWC lead for Blaupunkt 2010> Key 1/ Key2/ GND	OFF	ON	OFF
		OFF	ON	ON
	SWC lead for China HU Key1/ Key2/ GND	OFF	ON	OFF
	SWC lead for ESX Key1/ Key2	OFF	ON	OFF
	SWC lead for Kenwood 2020> Key1 / Key2 / GND	OFF	ON	OFF
		OFF	ON	ON
	SWC lead for Snooper Key1 / Key2	OFF	ON	OFF
	SWC lead for X Zent Key1/ Key2/ GND	OFF	ON	OFF
	SWC lead for radios with analogue teaching function	OFF	ON	OFF
42arc100	SWC multilead für various radios	X	X	X
42arc101	SWC lead for Alpine 3,5mm jack	OFF	OFF	OFF
42arc103	SWC lead for Blaupunkt 2010> Mini-Iso	ON	OFF	OFF
42arc104	SWC lead for Clarion	ON	ON	OFF
	SWC lead for JVC 3,5mm jack	ON	OFF	ON
		ON	ON	ON
42arc105	SWC lead for JVC 1-cable connection (control system 1)	ON	OFF	ON
	SWC lead for JVC 1-cable connection (control system 2)	ON	ON	ON
	SWC lead for Kenwood 1-cable connection (control system 1)	ON	ON	ON
	SWC lead für Kenwood 1-cable connection (control system 2)	ON	OFF	ON
42arc107	SWC lead for Blaupunkt 2010> 3,5mm jack	OFF	ON	ON
	SWC lead Kenwood 2017> 3,5 mm jack (control system 1)	OFF	ON	OFF
	SWC lead Kenwood 2017> 3,5 mm jack (control system 2)	OFF	ON	ON
	SWC lead for Pioneer 3,5 mm jack	OFF	ON	ON
	SWC lead for Sony 3,5 mm jack (control system 1)	ON	OFF	OFF
	SWC lead for Sony 3,5 mm jack (control system 2)	OFF	ON	OFF
42arc1072	SWC lead for Pioneer 2021/2022> 3,5mm jack (radios with a shiny metallic back)	OFF	ON	ON
42arc108	SWC lead for Digitaldynamic	OFF	OFF	ON
	SWC lead for X Zent 1-Kabelanschluss			
	SWC lead for Zenec 1-Kabelanschluss			

Wiring Diagram

